

M100 Single Solid Doors

Ref: DS023

Cleanroom single, double or leaf & half doorset's comprised of:

- > Door Leaf: **Two external coated steel sheets** with various surface finishes folded & sealed.
- > Door Leaf core aluminium honeycomb or rockwool.
- > **Fully flush vision panel** (size options below).
- > **Door Frame** 100mm rebated frame with edges profiled to interlock flush with the M100 cleanroom partition system.
- > Door frame powder coated to any RAL classic colour.
- > Flush Mounting of door interlock controls & components.

Door Characteristics & Performance

- > Door Thickness: 40mm
- > Thickness of coated steel outer face: 6mm
- > Maximum frame width (Single Door 1200mm) (Double Door 2500mm) frame height (Single & Double 2700mm)
- > Standard ironmongery includes: Door closer - **AssaAbloy DC700 white**, Door Hinges - **Zoo ZHSS43 Stainless Steel Butt Hinges**, Pull Handle - **Zoo ZCS2D 300BS Stainless Steel Pull Handle 300mm long x ø19mm**, Push plate - stainless steel 75mm wide x 300mm long, Kick plate - Stainless steel to client requirements, Door base dropseal - **Zero Plus 364A**.

Door Ironmongery Options

Door Locks: Zoo ZDL00600RSS Door Deadlock With Euro cylinder Key Lock, Hoyles Integrated Magnetic Lock.
Pull & Lever Handles: Zoo ZCSG600E guardsman style Stainless Steel Pull Handle, Zoo ZCS030 RTD Stainless Steel Lever Handle.
Emergency Exit: Exidor 300Series Emergency Exit Push Bar.

Door Vision Panel Options

200mm wide x 1500mm high double glazed 0.6mm glass,
 600mm wide x 800mm high double glazed 0.6mm glass,
 300mm wide x 600mm high double glazed 0.6mm glass,
 600mm wide x 2200mm high double glazed 0.6mm glass.

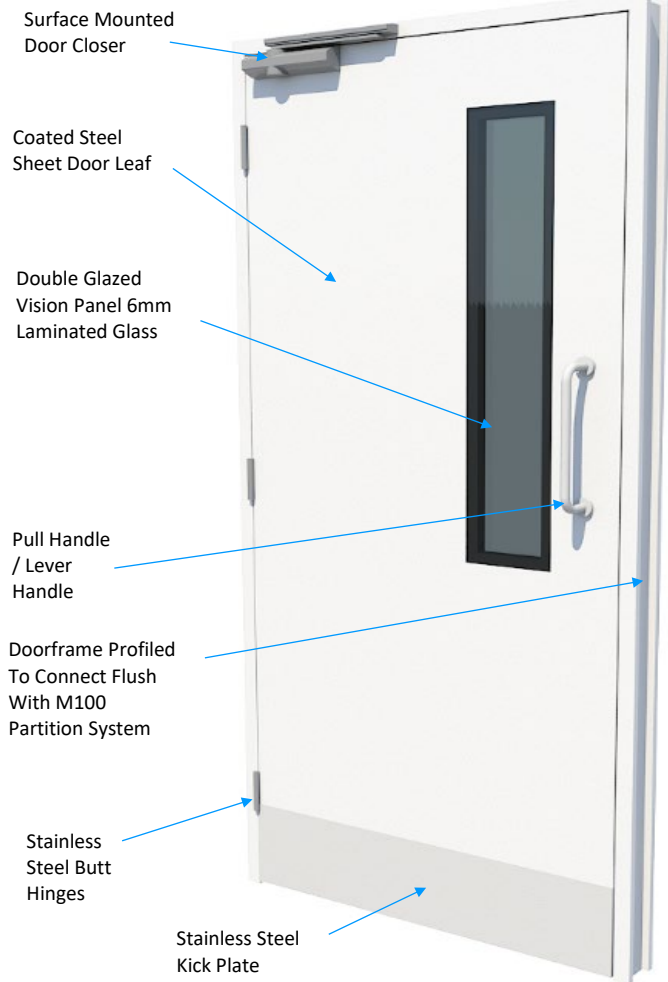

3D View

Packaging

Doors stacked on a wooden pallet max 5 doors high. Max pallet height: 2800mm, Max pallet width: 2500mm. Max pallet length: 2800mm, Protection to the vertical & horizontal corners of the stack. ISPM 15 certified crafting available on request for US market.

Door Leaf Finish Options

Standard Polyester Powdercoat steel finish to any RAL classic colour,
 PET coated steel finish to RAL 9010 white only,
 uPVC coated steel finish to RAL 9016 white

Note Door Frame Only Available in Polyester Powdercoat Finish to any RAL Classic Colour

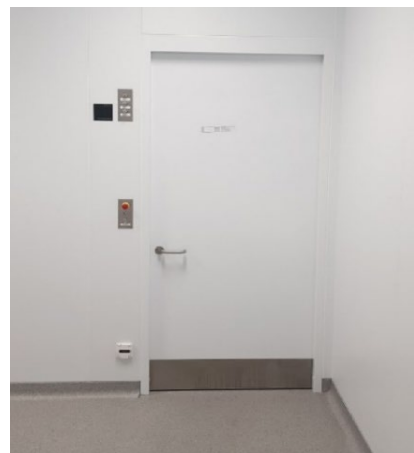

Ordering Options

M100 Door Ordering Numbering System Solid Single Leaf Door

M100 - SS - A - 0 - FF1 - LF1 - H1 - V1 - C1 - D1 - K1 - I1 - IL1

Product
M100 = M100
Cleanroom Door

Door Type
SS = Single Swing Door

Door Width
A = 900mm (Outside Frame)
775mm (Clear Width)
B = 1000mm (Outside Frame)
875mm (Clear Width)
C = 1100mm (Outside Frame)
975mm (Clear Width)
D = 1200mm (Outside Frame)
1075mm (Clear Width)

Door Height
0 = 2100mm (Outside Frame)
2005mm (Clear Height)
1 = 2200mm (Outside Frame)
2105mm (Clear Height)
2 = 2300mm (Outside Frame)
2205mm (Clear Height)
3 = 2500mm (Outside Frame)
2405mm (Clear Height)

Door Frame Finish (colour)
FF1 = Polyester Powdercoat To RAL 9010 White (to match PET coated panels)
FF2 = Polyester Powdercoat To RAL 9016 White (to match uPVC coated panels)
FF3 = Polyester Powdercoat To RAL 1018 Zinc Yellow
FF4 = Polyester Powdercoat To RAL 2008 Red Orange
FF5 = Polyester Powdercoat To RAL 3000 Flame Red
FF6 = Polyester Powdercoat To RAL 3020 Traffic Red
FF7 = Polyester Powdercoat To RAL 5015 Sky Blue
FF8 = Polyester Powdercoat To RAL 5017 Traffic Blue
FF9 = Polyester Powdercoat To RAL 6003 Olive Green
FF10 = Polyester Powdercoat To RAL 6018 Yellow Green
FF11 = Polyester Powdercoat To RAL 6037 Pastel Turquoise
FF12 = Polyester Powdercoat To RAL 7021 Black Grey
FF13 = Polyester Powdercoat To RAL 7042 Traffic Grey
FF14 = Polyester Powdercoat To RAL 9005 Jet Black

Door Leaf Finish (colour)
LF1 = PET Coated Steel
LF1 = uPVC Coated Steel
FF3 = Polyester Powdercoat To RAL 1018 Zinc Yellow
FF4 = Polyester Powdercoat To RAL 2008 Red Orange
FF5 = Polyester Powdercoat To RAL 3000 Flame Red
FF6 = Polyester Powdercoat To RAL 3020 Traffic Red
FF7 = Polyester Powdercoat To RAL 5015 Sky Blue
FF8 = Polyester Powdercoat To RAL 5017 Traffic Blue
FF9 = Polyester Powdercoat To RAL 6003 Olive Green
FF10 = Polyester Powdercoat To RAL 6018 Yellow Green
FF11 = Polyester Powdercoat To RAL 6037 Pastel Turquoise
FF12 = Polyester Powdercoat To RAL 7021 Black Grey
FF13 = Polyester Powdercoat To RAL 9005 Jet Black

Door Hinge Type
H1 = Stainless Steel Grade 316L Butt Hinge

Vision Panel
V1 = No Vision Panel
V2 = 200mm Wide x 1500mm Long (Part M Compliant)
V3 = 600mm Wide x 800mm Long (Standard Type)
V4 = 300mm Wide x 600mm Long (Small Type)
V5 = 600mm Wide x 2200mm Long (Maximum Size)
V6 = Custom Size To Clients Requirements **Contact Us**

Door Closer (Fitted to pull side)
C1 = None
C2 = Geze TS2000 NV Rack & Pinion Arm White
C3 = Geze TS4000 Rack & Pinion Arm White with 90° Stop & Hold Open
C4 = Geze TS5000 Slide Channel White with 90° Stop & Hold Open

Door Dropseal To Base of Door
D1 = None
D2 = Adjustable Dropseal

Door Kickplate
K1 = None
K2 = Stainless Steel Grade 316L 200mm High Push Side Only
K3 = Stainless Steel Grade 316L 200mm High Pull Side Only
K4 = Stainless Steel Grade 316L 200mm High Push & Pull Side
K5 = Stainless Steel Grade 316L 500mm High Push Side Only
K6 = Stainless Steel Grade 316L 500mm High Pull Side Only
K7 = Stainless Steel Grade 316L 500mm High Push & Pull Side
K8 = Stainless Steel Grade 316L 850mm High Push Side Only
K9 = Stainless Steel Grade 316L 850mm High Pull Side Only
K10 = Stainless Steel Grade 316L 850mm High Push & Pull Side

Door Ironmongery
I1 = None (reinforcement provided for client ironmongery)
I2 = Grade 316L Stainless Steel Straight Pull Handle 300mm Long Ø22mm & Grade 316L Stainless Steel Push Plate 350mm Long x 75mm Wide
I3 = Grade 316L Stainless Steel Straight Pull Handle 300mm Long Ø22mm To Both Sides Of Door
I4 = Grade 316L Stainless Offset Pull Handle 300mm Long Ø32mm & Grade 316L Stainless Steel Push Plate 350mm Long x 75mm Wide
I5 = Grade 316L Stainless Steel Offset Pull Handle 300mm Long Ø32mm To Both Sides Of Door
I6 = Leaver Handle To Both Sides of Door With Standard Lock Case
I7 = Leaver Handle To Both Sides Of Door With Eurocylinder Key Lock Case
I8 = Leaver Handle To Both Sides & Thumbturn To Pull Side With Coin Lock To Push Side
I9 = Leaver Handle To Both Sides & Thumbturn To Push Side With Coin Lock To Pull Side

Door Interlocking
IL1 = None
IL2 = Integrated Door Maglock Only Client Installed Traffic Light & Push Button
IL3 = Integrated Door Maglock With Traffic Light & Push Button (Normally Closed Door Interlock System)
IL4 = Integrated Door Maglock With Traffic Light only (Normally Open Door Interlock System)
IL5 = Integrated Door Maglock With Push Button Only (Normally Closed Door Interlock System)
IL6 = Integrated Door Maglock With Traffic Light & Wave Sensor (Normally Closed Door Interlock System)

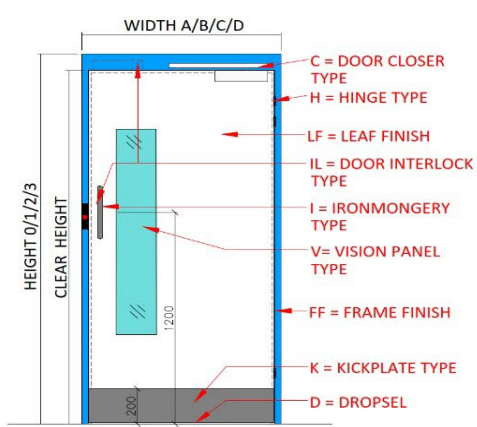
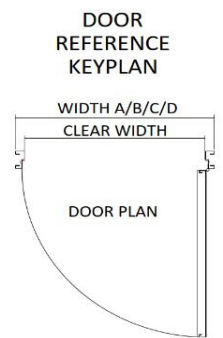

All information provided in this document is subject to legal disclaimers. It is the sole responsibility of the purchaser to determine the suitability of materials, products and components, in order to ensure that the final end-use product is safe for its end use; performs or functions as intended; and complies with all applicable legal and regulatory requirements.

M100 Double Solid Doors

Ref: DS023

Cleanroom double doorset's comprised of:

- > Door Leaf: **Two external coated steel sheets** with various surface finishes folded & sealed.
- > Door Leaf core aluminium honeycomb or rockwool.
- > **Fully flush vision panel** (size options below).
- > **Door Frame** 100mm rebated frame with edges profiled to interlock flush with the M100 cleanroom partition system.
- > Door frame powder coated to any RAL classic colour.
- > Flush Mounting of door interlock controls & components.

Door Characteristics & Performance

- > Door Thickness: 40mm
- > Thickness of coated steel outer face: 6mm
- > Maximum frame width (Single Door 1200mm) (Double Door 2500mm) frame height (Single & Double 2700mm)
- > Standard ironmongery includes: Door closer - **AssaAblay DC700 white**, Door Hinges - **Zoo ZHSS43 Stainless Steel Butt Hinges**, Pull Handle - **Zoo ZCS2D 300BS Stainless Steel Pull Handle 300mm long x ø19mm**, Push plate - stainless steel 75mm wide x 300mm long, Kick plate - Stainless steel to client requirements, Door base dropseal- **Zero Plus 364A**.

Door Ironmongery Options

- Door Locks:** Zoo ZDL00600RSS Door Deadlock With Euro cylinder Key Lock, Hoyles Integrated Magnetic Lock.
- Pull & Lever Handles:** Zoo ZCSG600E guardsman style Stainless Steel Pull Handle, Zoo ZCS030 RTD Stainless Steel Lever Handle.
- Emergency Exit:** Exidor 300Series Emergency Exit Push Bar.

Door Vision Panel Options

- 200mm wide x 1500mm high double glazed 0.6mm glass,
- 600mm wide x 800mm high double glazed 0.6mm glass,
- 300mm wide x 600mm high double glazed 0.6mm glass,
- 600mm wide x 2200mm high double glazed 0.6mm glass.

CLEANROOM.net

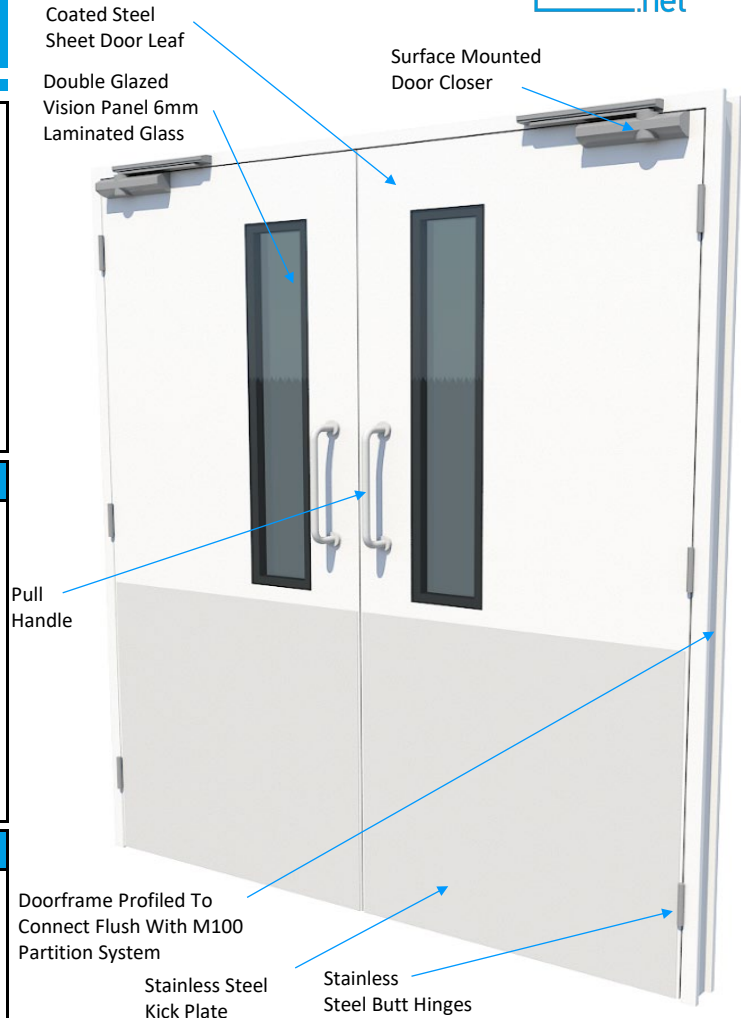

3D View

Packaging

Doors stacked on a wooden pallet max 5 doors high. Max pallet height: 2800mm, Max pallet width: 2500mm. Max pallet length: 2800mm, Protection to the vertical & horizontal corners of the stack. ISPM 15 certified crafting available on request for US market.

Door Leaf Finish Options

Standard Polyester Powdercoat steel finish to any RAL classic colour, PET coated steel finish to RAL 9010 white only, uPVC coated steel finish to RAL 9016 white

Note Door Frame Only Available in Polyester Powdercoat Finish to any RAL Classic Colour



Ordering Options

M100 Door Ordering Numbering System Solid Double Leaf Door

PE50 - DS - A - 0 - FF1 - LF1 - H1 - V1 - C1 - D1 - K1 - I1 - IL1

Product
PE50 = PE50
Cleanroom Door

Door Type
DS = Double Swing Door

Door Width
A = 2000mm (Outside Frame)
1875mm (Clear Width)
B = 2200mm (Outside Frame)
2075mm (Clear Width)
C = 2400mm (Outside Frame)
2275mm (Clear Width)
D = 2600mm (Outside Frame)
2475mm (Clear Width)

Door Height
0 = 2100mm (Outside Frame)
2005mm (Clear Height)
1 = 2200mm (Outside Frame)
2105mm (Clear Height)
2 = 2300mm (Outside Frame)
2205mm (Clear Height)
3 = 2500mm (Outside Frame)
2405mm (Clear Height)

Door Frame Finish (colour)
FF1 = Polyester Powdercoat To RAL 9010 White (to match PET coated panels)
FF2 = Polyester Powdercoat To RAL 9016 White (to match uPVC coated panels)
FF3 = Polyester Powdercoat To RAL 1018 Zinc Yellow
FF4 = Polyester Powdercoat To RAL 2008 Red Orange
FF5 = Polyester Powdercoat To RAL 3000 Flame Red
FF6 = Polyester Powdercoat To RAL 3020 Traffic Red
FF7 = Polyester Powdercoat To RAL 5015 Sky Blue
FF8 = Polyester Powdercoat To RAL 5017 Traffic Blue
FF9 = Polyester Powdercoat To RAL 6003 Olive Green
FF10 = Polyester Powdercoat To RAL 6018 Yellow Green
FF11 = Polyester Powdercoat To RAL 6037 Pastel Turquoise
FF12 = Polyester Powdercoat To RAL 7021 Black Grey
FF13 = Polyester Powdercoat To RAL 7042 Traffic Grey
FF14 = Polyester Powdercoat To RAL 9005 Jet Black

Door Leaf Finish (colour)
LF1 = PET Coated Steel
LF1 = uPVC Coated Steel
FF3 = Polyester Powdercoat To RAL 1018 Zinc Yellow
FF4 = Polyester Powdercoat To RAL 2008 Red Orange
FF5 = Polyester Powdercoat To RAL 3000 Flame Red
FF6 = Polyester Powdercoat To RAL 3020 Traffic Red
FF7 = Polyester Powdercoat To RAL 5015 Sky Blue
FF8 = Polyester Powdercoat To RAL 5017 Traffic Blue
FF9 = Polyester Powdercoat To RAL 6003 Olive Green
FF10 = Polyester Powdercoat To RAL 6018 Yellow Green
FF11 = Polyester Powdercoat To RAL 6037 Pastel Turquoise
FF12 = Polyester Powdercoat To RAL 7021 Black Grey
FF13 = Polyester Powdercoat To RAL 9005 Jet Black

Door Hinge Type
H1 = Stainless Steel Grade 316L Butt Hinge

Vision Panel
V1 = No Vision Panel
V2 = 200mm Wide x 1500mm Long (Part M Compliant)
V3 = 600mm Wide x 800mm Long (Standard Type)
V4 = 300mm Wide x 600mm Long (Small Type)
V5 = 600mm Wide x 2200mm Long (Maximum Size)
V6 = Custom Size To Clients Requirements **Contact Us**

Door Closer (Fitted to pull side)
C1 = None
C2 = Geze TS2000 NV Rack & Pinion Arm White
C3 = Geze TS4000 Rack & Pinion Arm White with 90° Stop & Hold Open
C4 = Geze TS5000 Slide Channel White with 90° Stop & Hold Open

Door Dropseal To Base of Door
D1 = None
D2 = Adjustable Dropseal

Door Kickplate
K1 = None
K2 = Stainless Steel Grade 316L 200mm High Push Side Only
K3 = Stainless Steel Grade 316L 200mm High Pull Side Only
K4 = Stainless Steel Grade 316L 200mm High Push & Pull Side
K5 = Stainless Steel Grade 316L 500mm High Push Side Only
K6 = Stainless Steel Grade 316L 500mm High Pull Side Only
K7 = Stainless Steel Grade 316L 500mm High Push & Pull Side
K8 = Stainless Steel Grade 316L 850mm High Push Side Only
K9 = Stainless Steel Grade 316L 850mm High Pull Side Only
K10 = Stainless Steel Grade 316L 850mm High Push & Pull Side

Door Ironmongery
I1 = None (reinforcement provided for client ironmongery)
I2 = Grade 316L Stainless Steel Straight Pull Handle 300mm Long Ø22mm & Grade 316L Stainless Steel Push Plate 350mm Long x 75mm Wide
I3 = Grade 316L Stainless Steel Straight Pull Handle 300mm Long Ø22mm To Both Sides Of Door
I4 = Grade 316L Stainless Offset Pull Handle 300mm Long Ø32mm & Grade 316L Stainless Steel Push Plate 350mm Long x 75mm Wide
I5 = Grade 316L Stainless Offset Pull Handle 300mm Long Ø32mm To Both Sides Of Door
I6 = Leaver Handle To Both Sides of Door With Standard Lock Case
I7 = Leaver Handle To Both Sides Of Door With Eurocylinder Key Lock Case
I8 = Leaver Handle To Both Sides & Thumbturn To Pull Side With Coin Lock To Push Side
I9 = Leaver Handle To Both Sides & Thumbturn To Push Side With Coin Lock To Pull Side

Door Interlocking
IL1 = None
IL2 = Integrated Door Maglock Only Client Installed Traffic Light & Push Button
IL3 = Integrated Door Maglock With Traffic Light & Push Button (Normally Closed Door Interlock System)
IL4 = Integrated Door Maglock With Traffic Light only (Normally Open Door Interlock System)
IL5 = Integrated Door Maglock With Push Button Only (Normally Closed Door Interlock System)
IL6 = Integrated Door Maglock With Traffic Light & Wave Sensor (Normally Closed Door Interlock System)

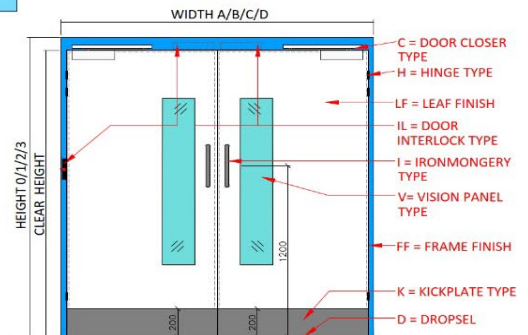
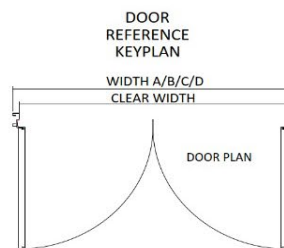

All information provided in this document is subject to legal disclaimers. It is the sole responsibility of the purchaser to determine the suitability of materials, products and components, in order to ensure that the final end-use product is safe for its end use; performs or functions as intended; and complies with all applicable legal and regulatory requirements.