

PE 15 Liner System

Ref: DS032

Cleanroom partition panel comprised of:

- > One external Coated Steel Sheet with various surface finishes.
- > Bonded to a 13mm Moisture Resistant Plasterboard Core.
- > Coated Steel sheet wraparound the plasterboard core on all four edges .
- > Folded coated steel Supporting Edge Flange to bottom & / or right hand side with Ø6mm holes at 150mm centres to allow mechanical fixing to existing wall, panel can also be bonded to existing wall (recommended adhesive Soudal Fixall Turbo).
- > Panel to be installed 100mm above finished floor level to create a recessed base for flush flooring installation.

Panel Characteristics & Performance

- > Panel Thickness: 15mm
- > Thickness of coated steel outer face: 0.6mm
- > Weight: 15kg/m²
- > Fire Classification: A2-s1-d0
- > Panel Width: 1202mm
- > Panel Height: 2870mm
- > Maximum weight for items fixed to partition 15kg

Panel Finish Options

Panel Surface Finish Options

- > PET Coated Steel Substrate to RAL 9010 White (TATA Advantica CL Clean) (for silicone joints)
 - > uPVC Coated Steel Substrate to RAL 9010 White (TATA Advantica L Control) (for cold weld and silicone joints)
 - > uPVC Coated Steel Substrate to RAL 9016 Bright White (Lampre pre-coated) (for cold weld and silicone joints)
- For other finishes please contact us

Panel Options

Panel Core Options

- > Type 1 Folded Supporting Edge Flange to Bottom Only.
- > Type 2 Folded Supporting Edge Flange to Bottom & Right Hand Side.

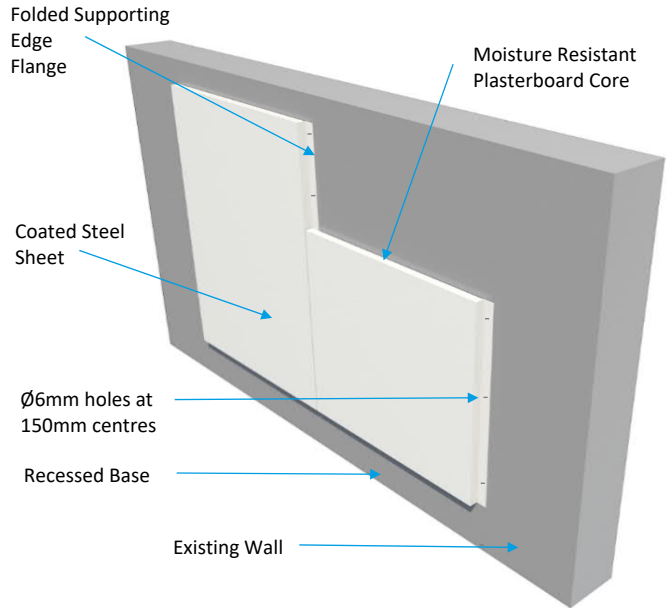

3D View

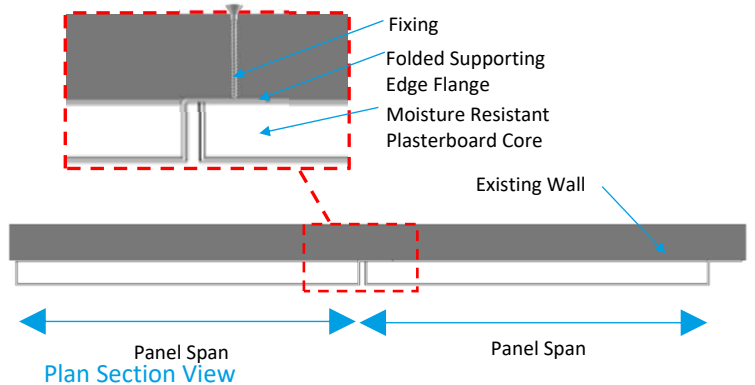

Packaging

Panels stacked on a wooden pallet max 30 panels high. Max pallet height: 1500mm, Max pallet width: 1280mm. Max pallet length: 2900mm, Protection to the vertical & horizontal corners of the stack. ISPM 15 certified crafting available on request for US market.



Ordering Options							
Type 1 Folded Supporting Edge Flange to Bottom Only							
Panel Size	Panel Finish	PET (RAL9010)		uPVC (RAL9010)		uPVC (RAL9016)	
Order Code							
1200 x 2870		PS_PE15_569001-PET-1202-2870		PS_PE15_569001-PVCA-1202-2870		PS_PE15_569001-PVCB-1202-2870	
Type 2 Folded Supporting Edge Flange to Bottom & Right Hand Side.							
Panel Size	Panel Finish	PET (RAL9010)		uPVC (RAL9010)		uPVC (RAL 9016)	
Order Code							
1200 x 2870		PS_PE15_569002-PET-1202-2870		PS_PE15_569002-PVCA-1202-2870		PS_PE15_569002-PVCB-1202-2870	

Note: For non standard panel size please contact us.

Note: Fixings, Adhesive, Corner Coving & Sealant Sold Separately.

All information provided in this document is subject to legal disclaimers. It is the sole responsibility of the purchaser to determine the suitability of materials, products and components, in order to ensure that the final end-use product is safe for its end use; performs or functions as intended; and complies with all applicable legal and regulatory requirements.

CLEANROOM.net LTD
The Prince, Castlecomer,
Co. Kilkenny, R59 X8ER, Republic Of Ireland.

Tel: +353-56-449-1491
Email: Info@cleanroom.net
Web: www.cleanroom.net